

**Product Description:**

Included Quick Mount Plate for easy and contractor friendly installation

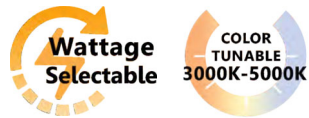
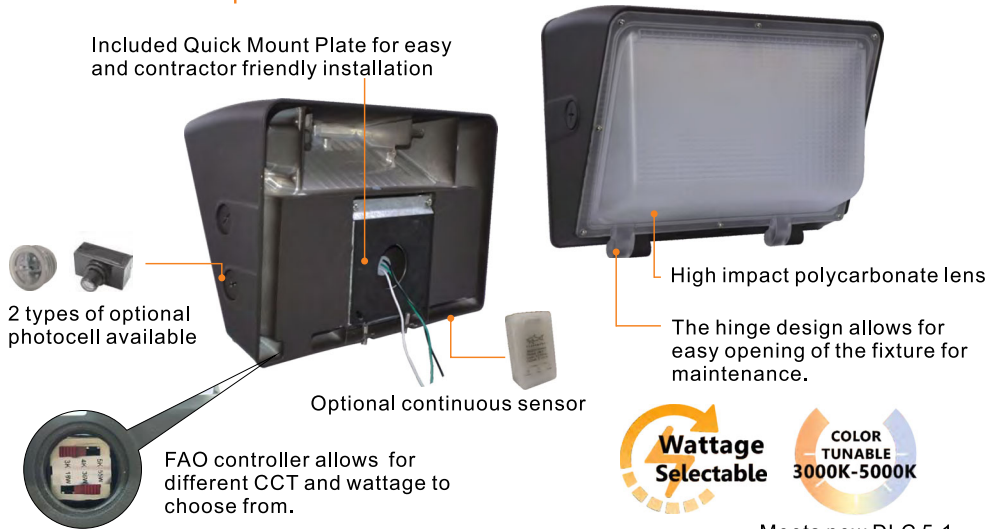

Meets new DLC 5.1 requirements

**Product Description:**

Utilizing the latest generation of LED Chips and a patented smart controller, this uniquely designed wall pack not only delivers a similar light output of a 150/200W metal halide, but it also has multiple wattage and CCT to choose from based on different environments. Housing made out of die-cast aluminum with reliable powder coating specifically for harsh outdoor environment. It is attractive in appearance and performance.

Optional Kelvin color\* with adder.

**Features:**

- LISTING**  
UL and CUL listed for wet locations
- HOUSING**  
Die-cast aluminum body
- FINISH**  
UV stabilized powder coated finish
- LENS**  
High impact polycarbonate lens
- OPTIONS**  
Finish - Bronze. Color option with adder  
Optional Photocontrol  
Optional continuous sensor

**Performance Data**

Model NO.	Nominal Watts**	Lumens**	Efficacy**
LED-6590	16/30/42/46W	6520 lm*	138 lm/W*
	21/41/61/71W	9886 lm*	138 lm/W*
	32/62/92/100W	14075 lm*	138 lm/W*

\* Lumen and Efficacy shows the highest wattage at 5000K

**Specification:**

Example: LED-6590

Model No.	Nominal Watts**	Input Voltage	CRI	Color* Temp	Option	Finish	Starting Temp
LED-6590	046=46W	UNV=120-277V	8=80+	TK=5000 K	XS= 10kV Surge 2S= 20kV Surge PC = Photocontrol OS = Occupancy Sensor	Bronze	-40°C ~ +40°C
	071=71W			/4000K			
	100=100W			/3000K			

\* Different LED Kelvin temperature available with 4-6 week lead time. Please call for a quote.  
\*\* DISCLAIMER: This test report was produced in accordance with IES LM-79 photometric testing protocol for luminaires, using a single representative test fixture. Actual production units may vary from the values reported here by up to ±10%.