

Product Description:

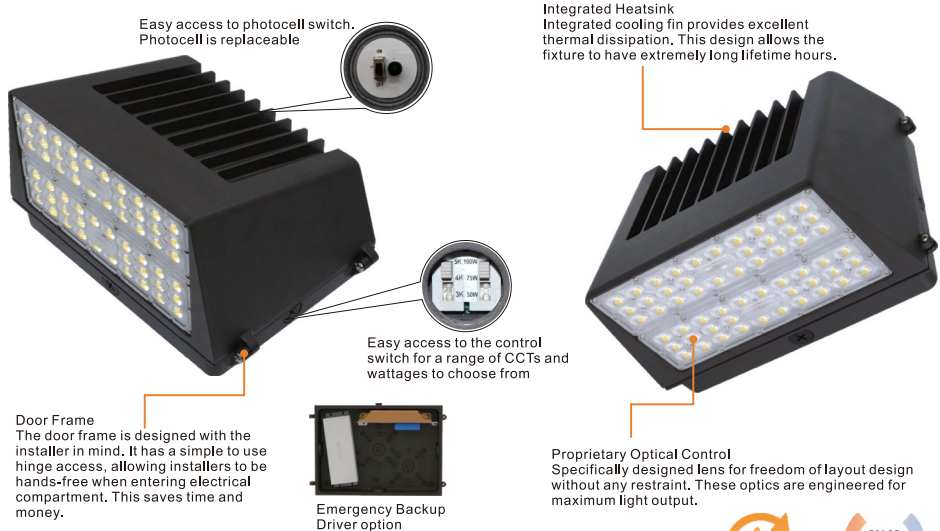

Product Description:

The LED-3120 is a powerful luminaire that has been designed to meet a wide variety of locations. With the various mounting options it can be used as a flood light or as an area light. With the LEDs mounted on the large heatsink, the fixture can maintain a high lumen output while keeping the LED modules at a cool temperature.

Optional Kelvin color\* with adder.

Features:

- LISTING**  
UL and CUL listed for wet locations
- HOUSING**  
Heavy duty die-cast aluminum powder coating, corrosion resistant hardware
- FINISH**  
UV stabilized powder coated finish
- LENS**  
Heat and impact PC Lens
- OPTIONS**  
Wide / narrow distribution available with adder  
Finish - Bronze. Color option with adder

Performance Data

Model NO.	System Watts	Lumens	LPW
LED-3120	60/80/110W	14169 lm**	130 lm/w
Lumen and Efficacy are based on the highest wattage at 5000K			

Specification:

Example: LED-3120

Model No.	System Watts	Input Voltage	CRI	Color Temp	Distribution	Option	Finish	Starting Temp
						Accessories		
LED-3120	110=110W	UNV=120-277V	7=70+	40=4000 K 50=5000 K	T3=Type III T4=Type IV	PE=Photocontrol EM=Emergency Driver FAO=FAO Controller	BZ=Bronze	-40°C

\* Different LED Kelvin temperature available with 4-6 week lead time. Please call for a quote.  
\*\* DISCLAIMER: This test report was produced in accordance with IES LM-79 photometric testing protocol for luminaires, using a single representative test fixture. Actual production units may vary from the values reported here by up to ±10%.

Dimension:

